

RECOMMENDED INSTALLATION PROCEDURE

LEVEL 3

Flat Wall Retrofit Aluminum & Vinyl Window Installation RB 975, Retro Flange Application

Products:

RainBuster #975 Advanced Polyether Sealant/Adhesive

Approved Low Expanding Foam by Others (non-RainBuster products)



Contact Top Industrial for Details

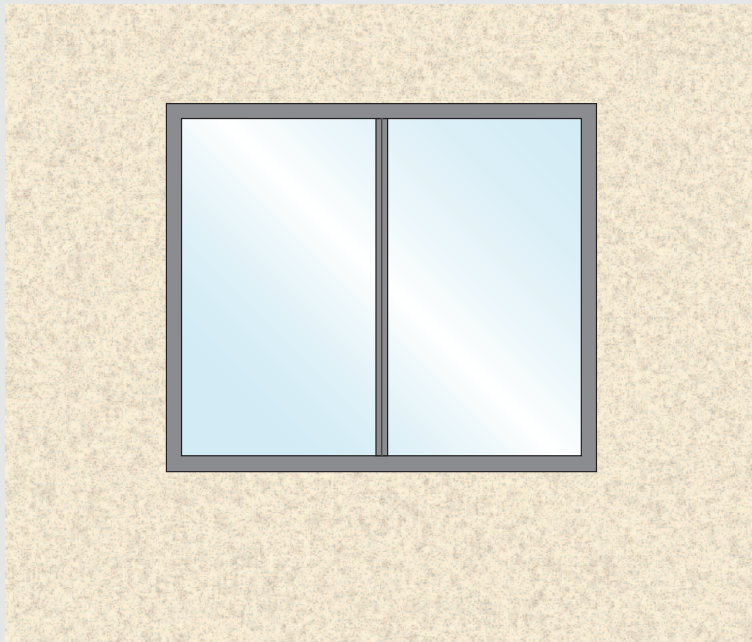

Preinstallation: Inspect Existing Window for Evidence of Moisture Intrusion

Inspect interior and exterior walls adjacent to the existing window for evidence of moisture intrusion. If evidence of moisture intrusion is present corrective measures must be taken prior to window installation. Alternative window installation methods may be required.

Verify existing window is plumb, level, and square.

Verify that retrofit window will fit into rough opening and that retro flange will cover the existing window frame.

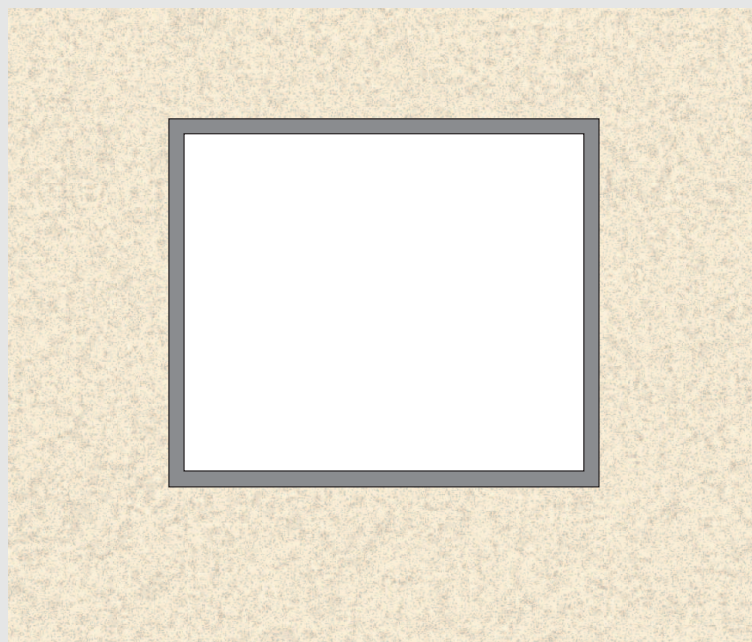

Step 1. Prepare Opening for Retrofit Window

- 1.A Remove the existing operable and fixed panels including the hardware and any other accessories (secondary locks, closers, etc.) that may protrude into the rough opening.
- 1.B Ensure that the exterior face of the existing window frame is clean, dry, and free of protrusions that will interfere with the retrofit window installation.

RECOMMENDED INSTALLATION PROCEDURE

LEVEL 3

Flat Wall Retrofit Aluminum & Vinyl Window Installation RB 975, Retro Flange Application

Products:

RainBuster #975 Advanced Polyether Sealant/Adhesive

Approved Low Expanding Foam by Others (non-RainBuster products)



Part of the...
RainBuster®
LEAK-FREE
SYSTEM

RAIN
BUSTER
Since 1983

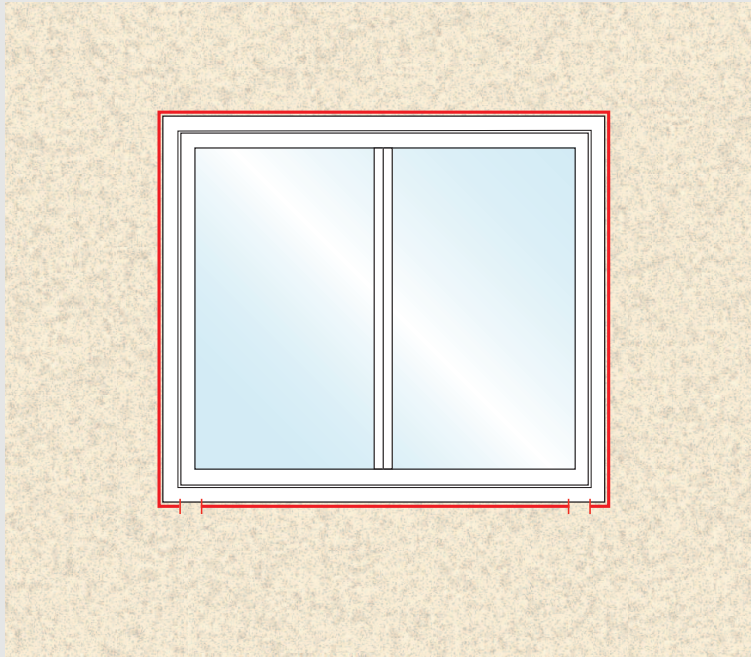

Step 2. Install Retrofit Window

Product: RainBuster #975 Advanced Polyether Sealant/Adhesive

- 2.A Apply a 3/8" continuous bead of sealant to the backside of the retro flange. Leave a 3" void in the sealant 2" in from either end of the retro flange at the sill of the window. Apply sealant, ensuring a continuous seal between the retro flange and the existing window frame.
- 2.B Sealant must be applied no longer than 20 minutes prior to installation of window.
- 2.C Install window per window manufacturer's installation specifications ensuring window is securely fastened and plumb, level, and square.

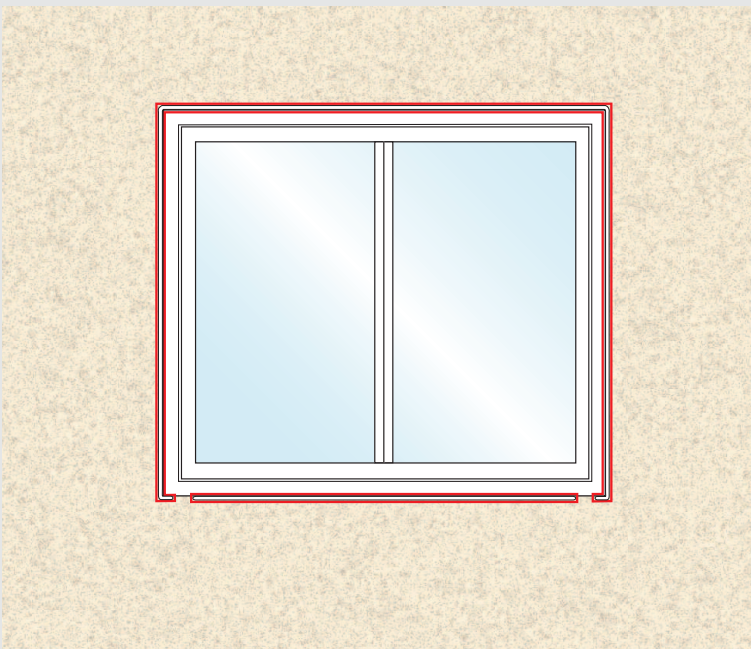

Step 3. Apply Secondary Bead of Sealant

Product: RainBuster #975 Advanced Polyether Sealant/Adhesive

- 3.A Apply a 3/8" secondary bead of sealant to the edge of the retro flange. Leave a 2" void in the sealant 2" in from either end of the retro flange at the sill of the window. Apply sealant, ensuring a continuous seal between the retro flange and the existing window frame/stucco/siding.
- 3.B Tool sealant into retro flange/stucco/siding joint ensuring continuous seal.

RECOMMENDED INSTALLATION PROCEDURE

LEVEL 3

Flat Wall Retrofit Aluminum & Vinyl Window Installation RB 975, Retro Flange Application

Products:

RainBuster #975 Advanced Polyether Sealant/Adhesive

Approved Low Expanding Foam by Others (non-RainBuster products)



Step 4. Apply Low Expanding Foam Insulation at Interior of Window

Product: Low expanding foam insulation by others (non-RainBuster products)

- 4.A Apply low expanding foam insulation between existing window frame and new window frame at interior of window. Follow low expanding foam insulation manufacturer's application recommendations. Foam insulation must meet AAMA 812 standard to avoid frame distortion.
- 4.B Allow foam insulation to cure prior to installing finish trim.
- 4.C Trim cured foam insulation as needed to accommodate interior finish trim installation.

Step 5. Install Finish Trim at Interior of Window

Product: Vinyl or wood trim by others (non-RainBuster products)

- 5.A Install finish trim to cover existing window frame and foam finishing installation.

Drawings Not to Scale



Installation Recommendations: It's recommended that backing (OSB, plywood, dimensional lumber) be installed to support flashing at all window and door openings. Installation substrates should be clean and free from substances and protrusions that could adversely affect adhesion and or compromise flashing/membrane performance. When an installation requires adhering RainBuster #415 Self-Adhered Flashing Membrane directly to the substrate (OSB, plywood, fiberglass faced gypsum board, masonry, and concrete) an adhesion test is recommended to ensure sufficient adhesion is achieved. Adhesion may be improved by rolling the membrane with a J-roller. In some cases priming the surface with an approved primer may be required to achieve sufficient adhesion. In 3-coat stucco applications, it's recommended that all flashing be covered by the Weather Resistive Barrier (WRB). After the WRB has been properly integrated (weather board/ship lap fashion) with the window and door flashing systems an additional piece of WRB should be installed over the sill flashing acting as a bond breaker.